



City of Yelm

Community Development Department
106 2ND Street SE
Yelm, WA 98597
360-458-3835

NOTICE OF APPLICATION
Mailed on: May 14, 2019

PROJECT NAME: Yelm Community Schools Facilities & Maintenance Building
PROJECT LOCATION: Ft. Stevens Elementary School Site, 16525 100th Way, Yelm, WA 98597
PROJECT PARCEL NUMBER: 64303600300
LAND USE CASE NUMBER: 20190142

An application submitted by Yelm Community Schools, PO Box 476, Yelm, WA 98597, for the above referenced project was received by the City of Yelm on April 29, 2019. The City has determined the application to be complete on May 14, 2019. The application and any related documents are available for public review during normal business hours at the City of Yelm, 106 2nd Street SE, Yelm WA. For additional information, please contact the Community Development Department at (360) 458-3835.

PROJECT DESCRIPTION: The applicant proposes to construct a 2,856 sq. ft. office building, with associated parking and upgraded stormwater facilities.

ENVIRONMENTAL and OTHER DOCUMENTS SUBMITTED WITH THE APPLICATION: A site plan and preliminary drainage report was submitted.

Additional Information or Project Studies Requested by the City: N/A

No preliminary determination of consistency with City development regulations has been made. At minimum, this project will be subject to the following plans and regulations: City of Yelm Comprehensive Plan, Unified Development Code Title 18 YMC, and the Stormwater Management Manual for Western Washington.

The City of Yelm invites your comments early in the review of this proposal. Comments should be directed to Tami Merriman, Community Development Department, 106 2nd Street SE, Yelm WA 98597, (360) 458-8496.

THE 15-DAY PUBLIC COMMENT PERIOD ENDS AT 5:00 PM ON MAY 29, 2019

This notice has been provided to appropriate local and state agencies, and property owners within 300 feet of the project site. These recipients will also receive the following items when available or if applicable: Environmental Threshold Determination, Notice of Public Hearing and Notice of Final Decision. If the proposed project requires a City Council decision, it will be mailed to all those who participate in the public hearing and to anyone else requesting the decision in writing. Additionally, there will be a 14-day public comment period if an environmental determination is issued. Opportunities for appeal occur within twenty one (21) days after the date the notice of decision is issued. City Council decision can be appealed through Superior Court.

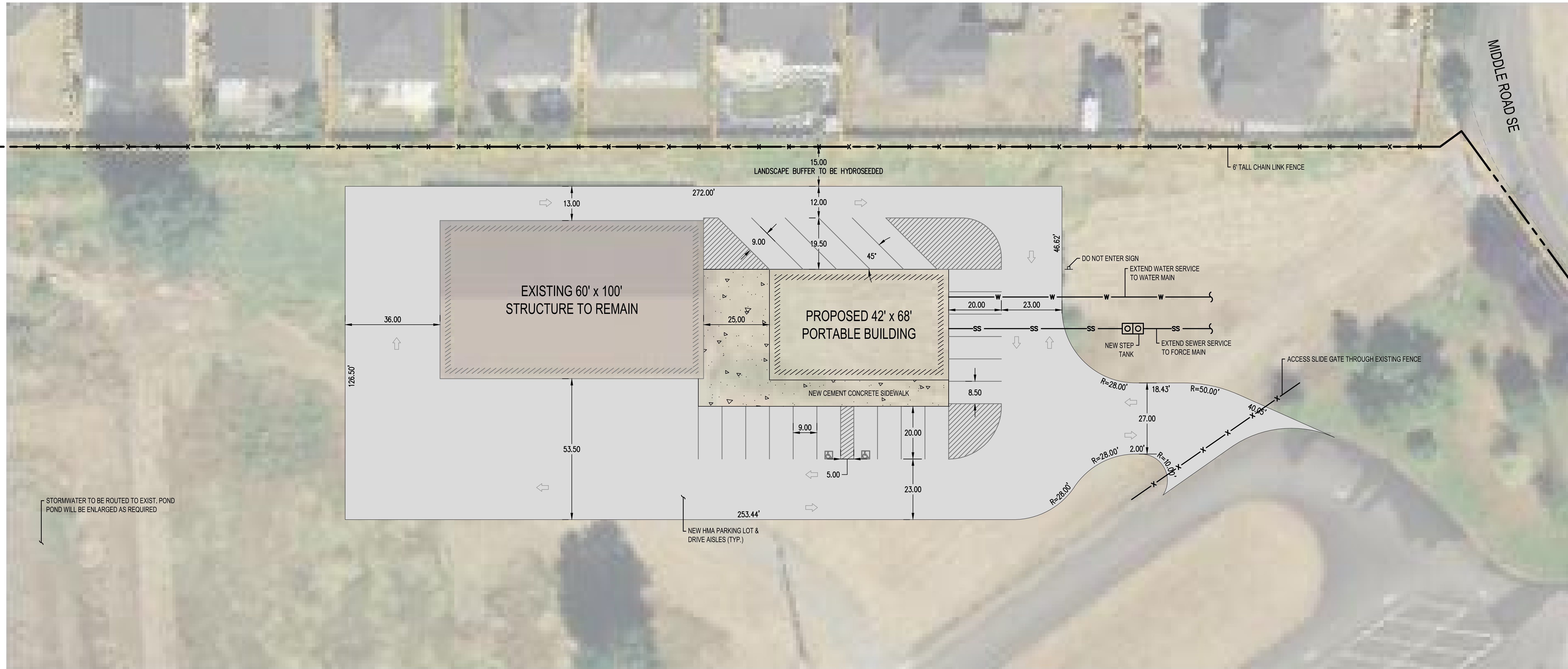

REVISIONS	DATE	BY

SCJ ALLIANCE
CONSULTING SERVICES
8730 TALLON LANE NE SUITE 200, LACEY, WA 98516
P: 360.352.1465 F: 360.352.1509
SCJALLIANCE.COM

SHEET TITLE:
SITE PLAN

PROJECT NAME:
YELM COMMUNITY SCHOOLS

DESIGNER:
DRAWN BY:
APPROVED BY:

DATE:
JOB NO:
DRAWING FILE NO:
DRAWING NO:
SHEET NO:
1 OF 1

PROJECT DETAILS

SITE ADDRESS 16525 100TH WAY SE
TAX PARCEL NO. 64303600300

PROPOSED ROOF AREA 2,856 SF
OTHER PROPOSED IMPERVIOUS SURFACES 28,000 SF

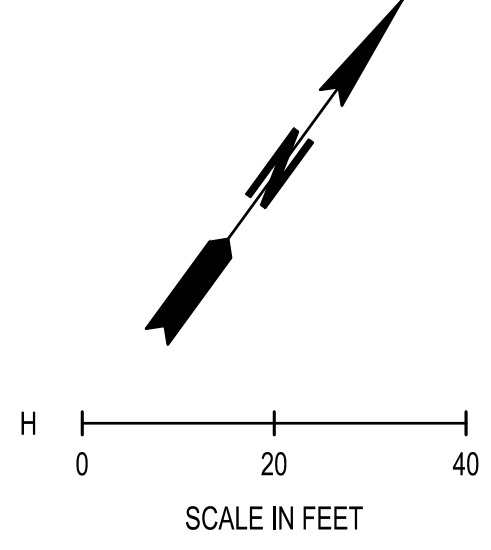

Apr 22, 2019 3:50:12pm - User: cdm.dahm
K:\PROJECTS\216 YELM SCHOOL DISTRICT\216.02 YCS FACILITIES AND MAINTENANCE BUILDING SITE IMPROVEMENTS\CADD\PRE APP SITE PLAN.DWG